

Install eSIM on Android phone or tablet (Printable version)

Prestart checklist

- ✓ A strong internet connection – Ideally, you will need to be on Wi-fi or have good 4G signal.
- ✓ An eSIM compatible device – If you are unsure, see list of compatible devices [here](#)
- ✓ Your device must not be locked to a single network.

- In this guide, we assume your main SIM is installed in Slot 1 and your new eSIM is installed in Slot 2.
- If you have a Google Pixel, an extra step is required to enable 2 SIMs. Click [here](#).
- If you have a Samsung phone or tablet, click [here](#) for our dedicated Samsung page.

PART 1: Install your eSIM using QR code

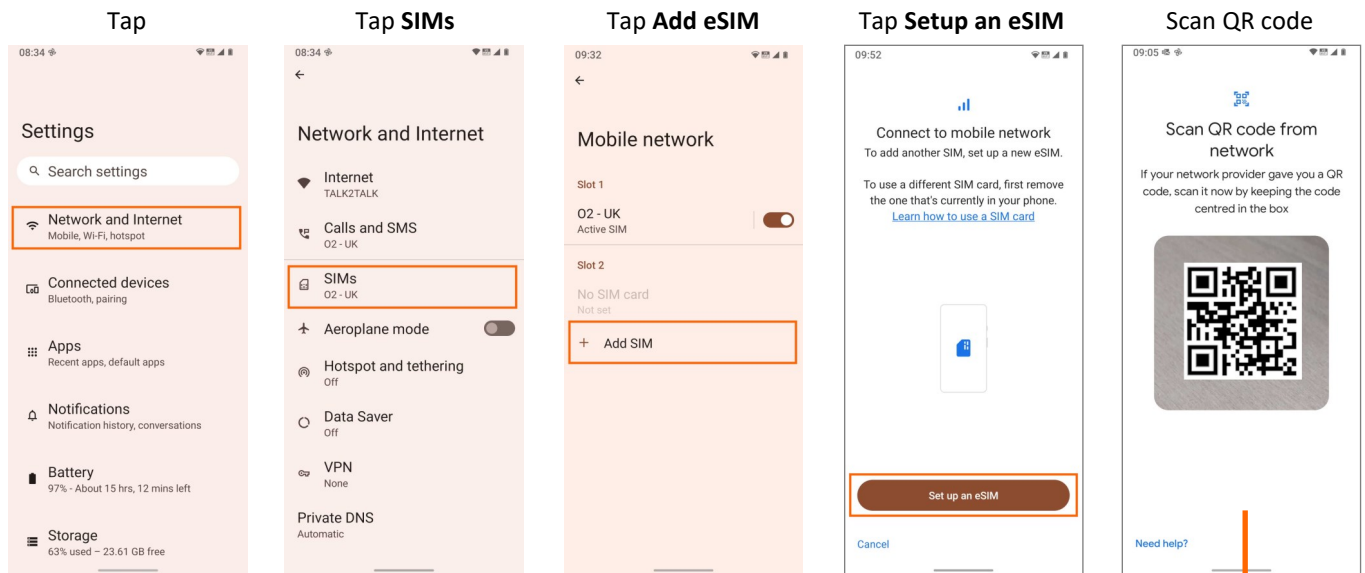

← Unable to scan QR code? extras steps below →

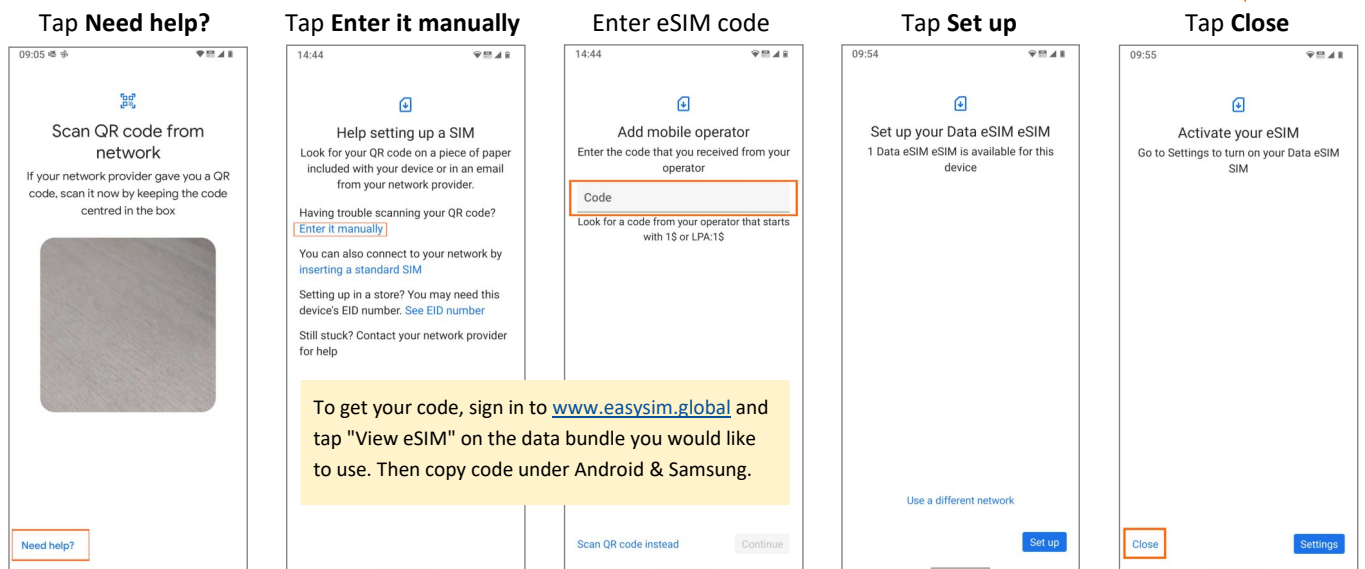

PART 1: Install your eSIM using QR code (continued)

Notes

- When installation is complete, you will notice 2 signal strengths at the top of your screen!

PART 2: Activate your data bundle

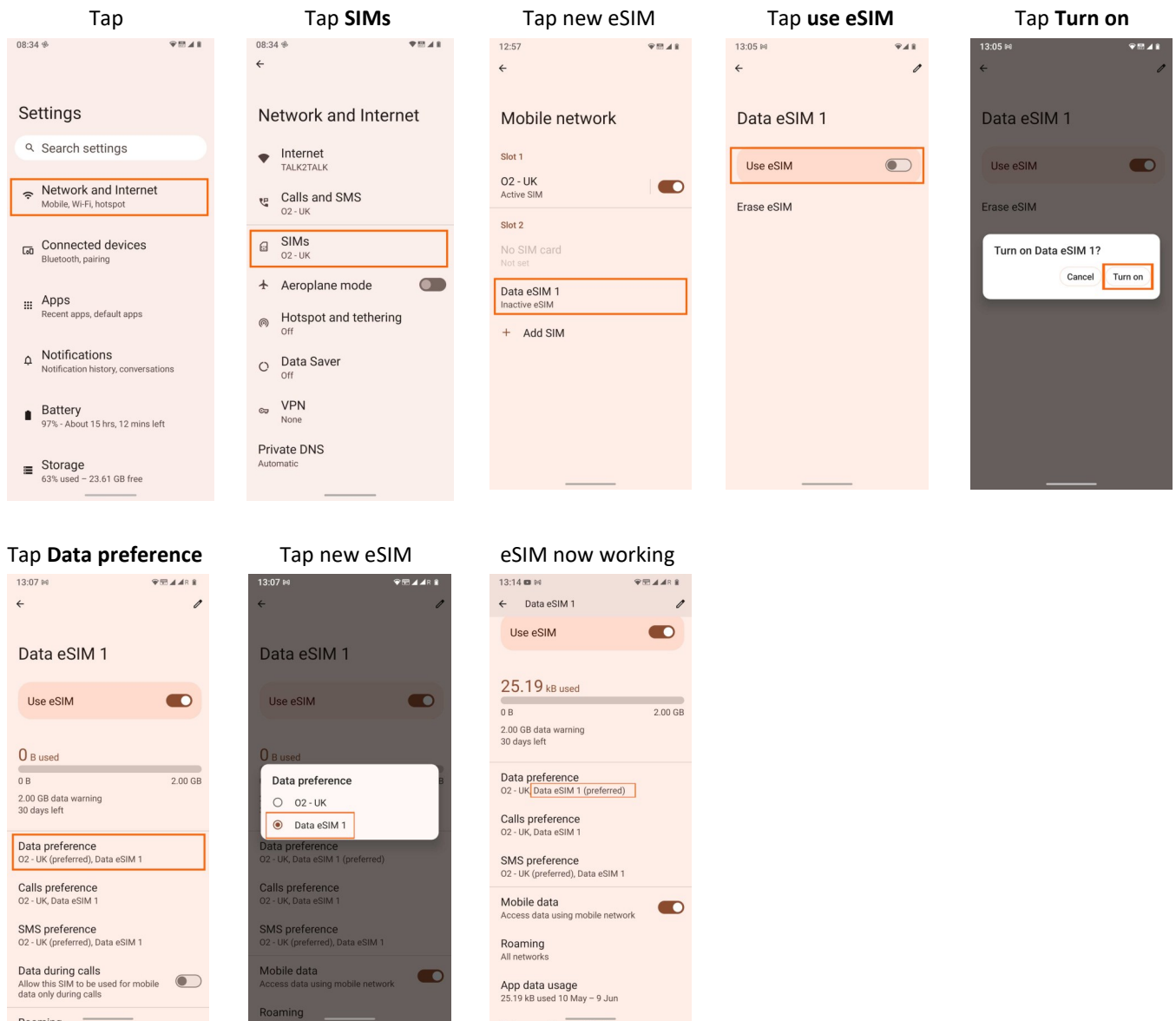

Tips

- Notice the two signal strengths at the top of your screen!
- The signal strength shown on the right is the one being used for "Mobile Data".
- To save battery, turn off your easySim if you're not using it.
- We suggest you name your eSIM "easy" so you can easily recognise it. To do this, click the edit pencil in top right corner of screen.